

PARTY'S COPY

Structural form and design calculation is submitted by the
No. 203/2008/11 Date: 02/11/2011
of the Kodava Municipal Corporation without verification No.
owner from the structural student per. Work for me
along with design calculation and safety certificate in the
prescribed form, necessary steps shall be taken for the
safety of human life and property.

M. J. M.
-Engineer (Civil) -
EXECUTIVE ENGINEER (CIVIL)
K. M. C. BUILDING
BR-VII

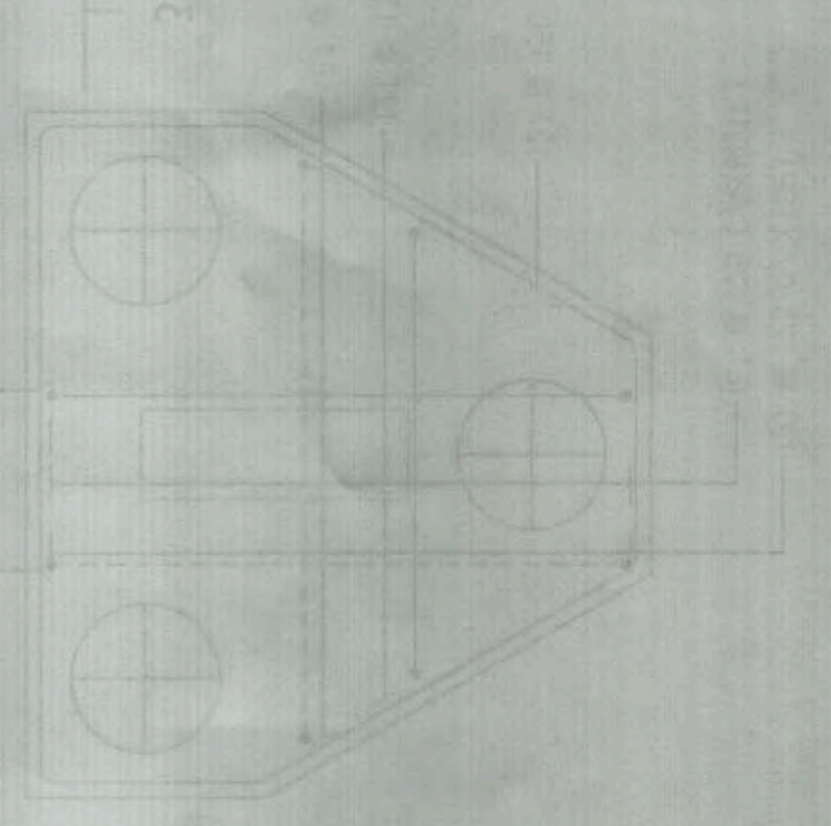

30'x17'-0" OF BITE CYB MKD-3E

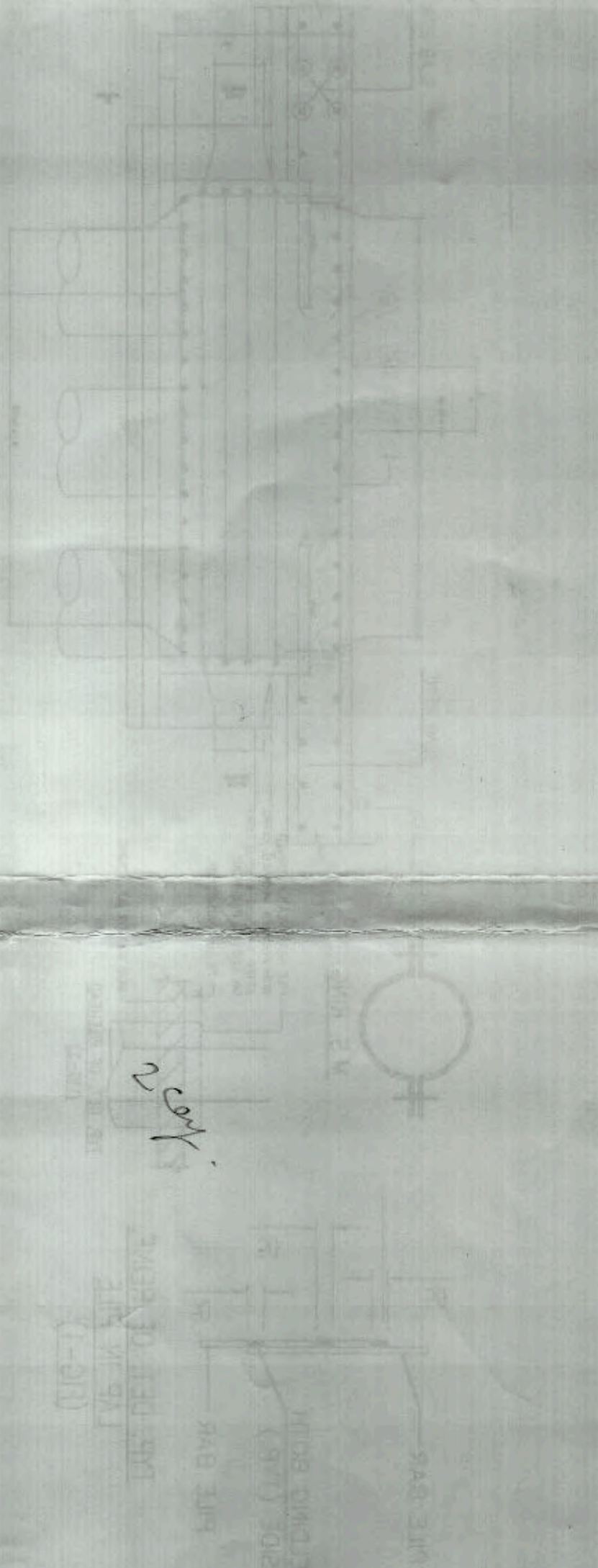

copy

DATE: 02/11/2011
TIME: 10:30 AM
PLACE: K.M.C. BUILDING
BR-VII

THE BEYVA SCHEDULE

Sl. No.	Particulars	Rate	Quantity	Amount
1	Excavation	100.00	100.00	10000.00
2	Foundation	200.00	100.00	20000.00
3	Structure	300.00	100.00	30000.00
4	Roofing	150.00	100.00	15000.00
5	Plumbing	100.00	100.00	10000.00
6	Electrical	100.00	100.00	10000.00
7	Painting	50.00	100.00	5000.00
8	Contingency	10.00	100.00	1000.00
9	Professional Fee	10.00	100.00	1000.00
10	Other	10.00	100.00	1000.00
Total				100000.00

30'x17'-0" OF BITE CYB MKD-3E

Sl. No.	Particulars	Rate	Quantity	Amount
1	Excavation	100.00	100.00	10000.00
2	Foundation	200.00	100.00	20000.00
3	Structure	300.00	100.00	30000.00
4	Roofing	150.00	100.00	15000.00
5	Plumbing	100.00	100.00	10000.00
6	Electrical	100.00	100.00	10000.00
7	Painting	50.00	100.00	5000.00
8	Contingency	10.00	100.00	1000.00
9	Professional Fee	10.00	100.00	1000.00
10	Other	10.00	100.00	1000.00
Total				100000.00

30'x17'-0" OF BITE CYB MKD-3E

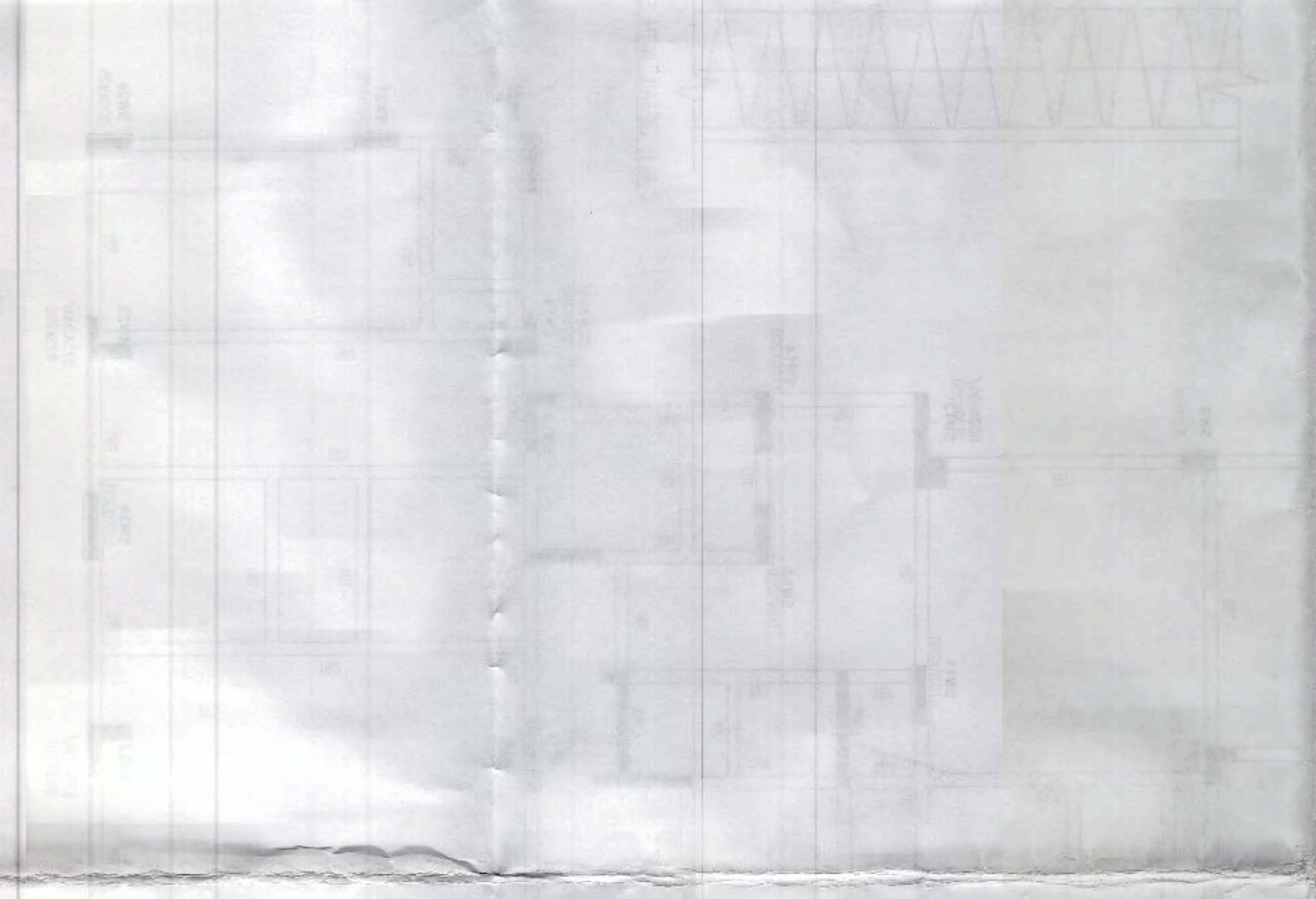

30'x17'-0" OF BITE CYB MKD-3E

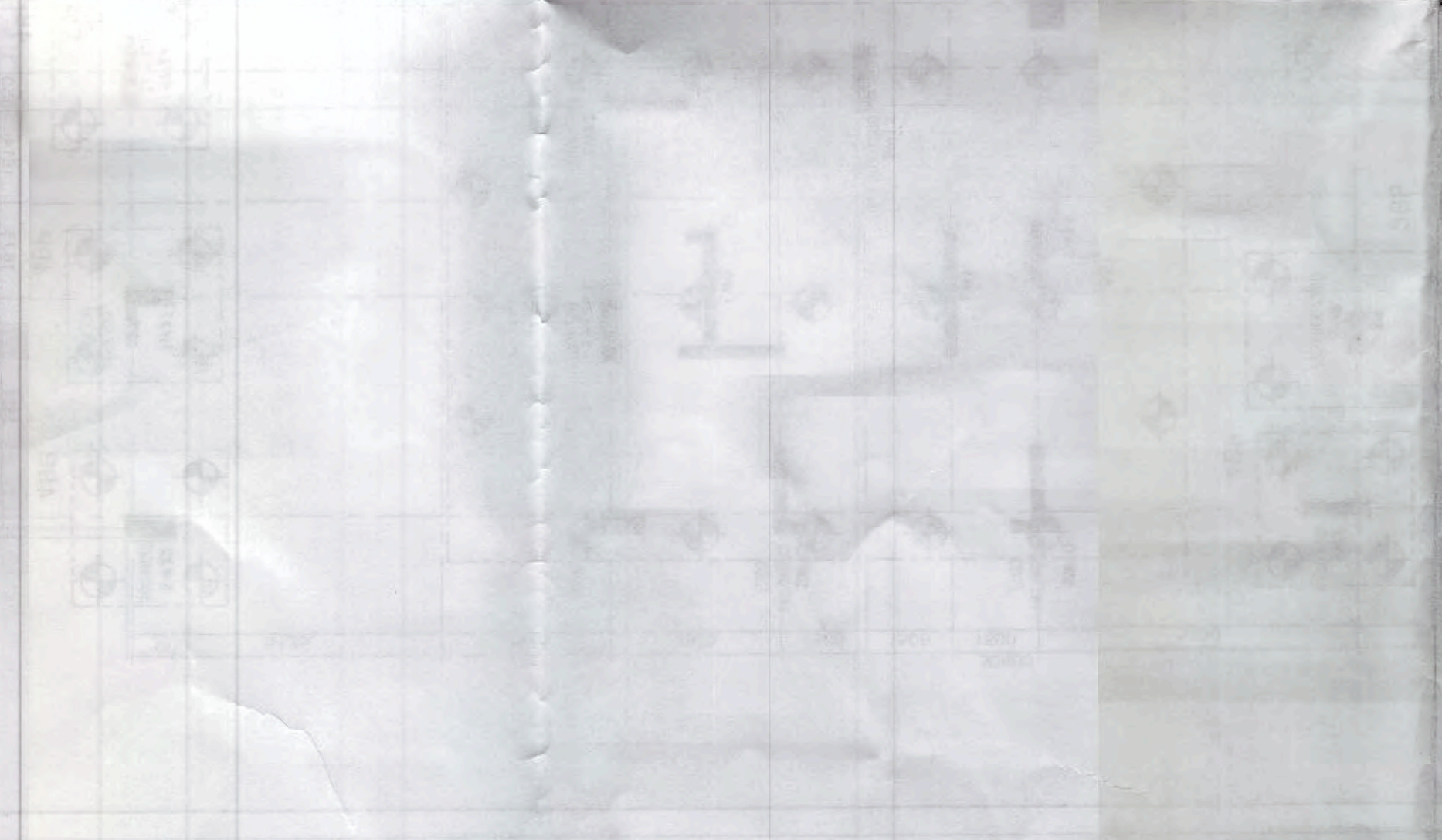

30'x17'-0" OF BITE CYB MKD-3E

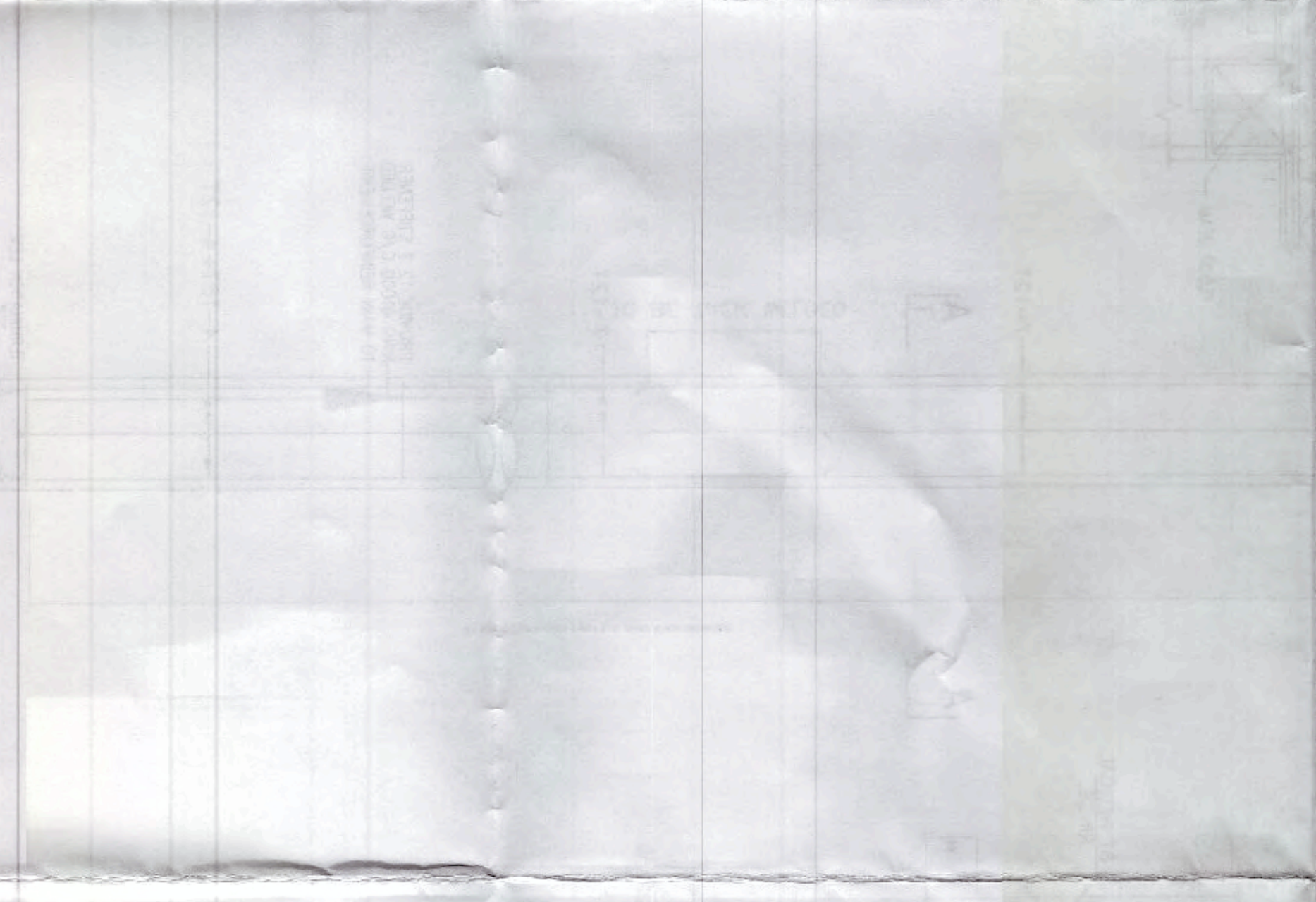

30'x17'-0" OF BITE CYB MKD-3E

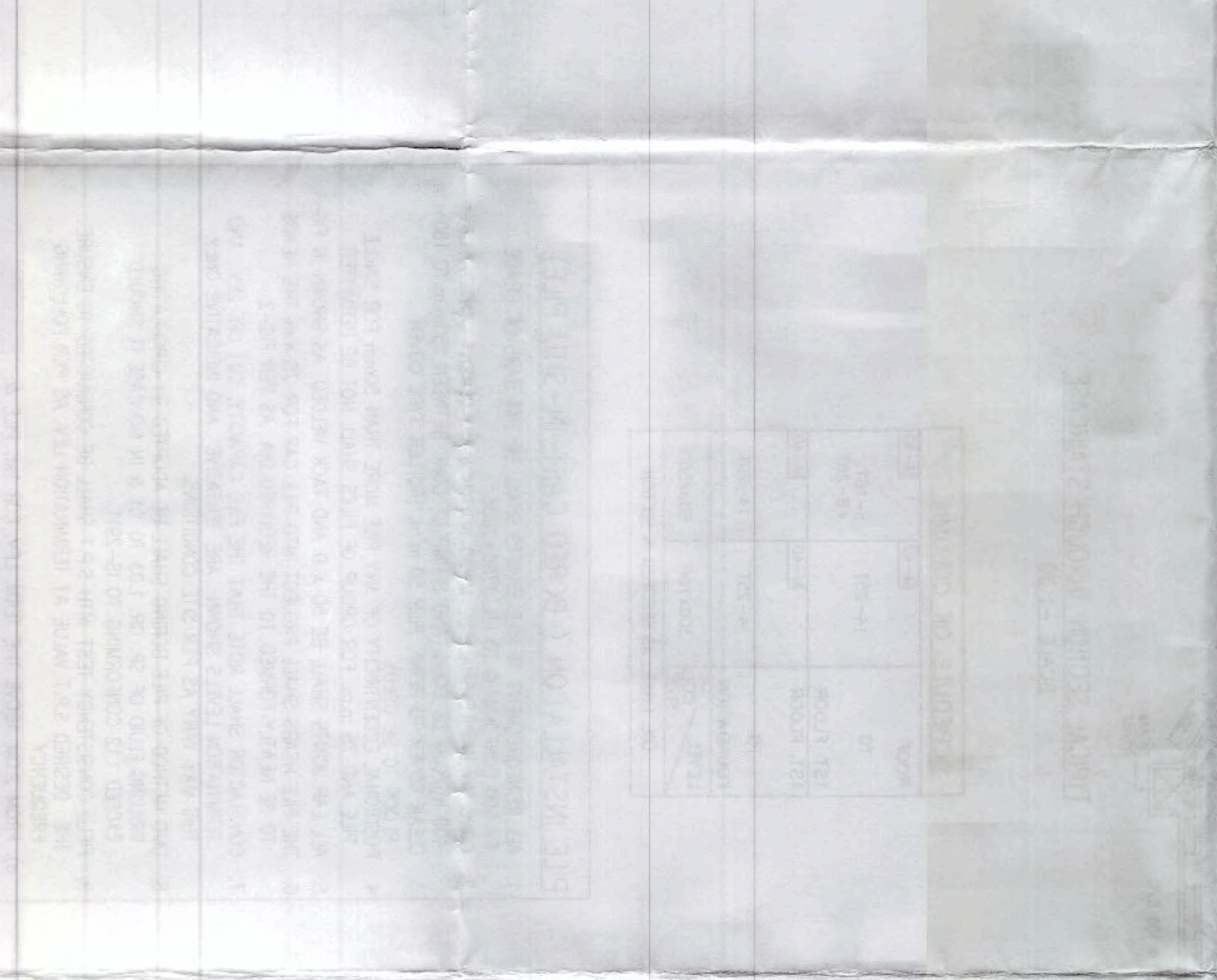

30'x17'-0" OF BITE CYB MKD-3E

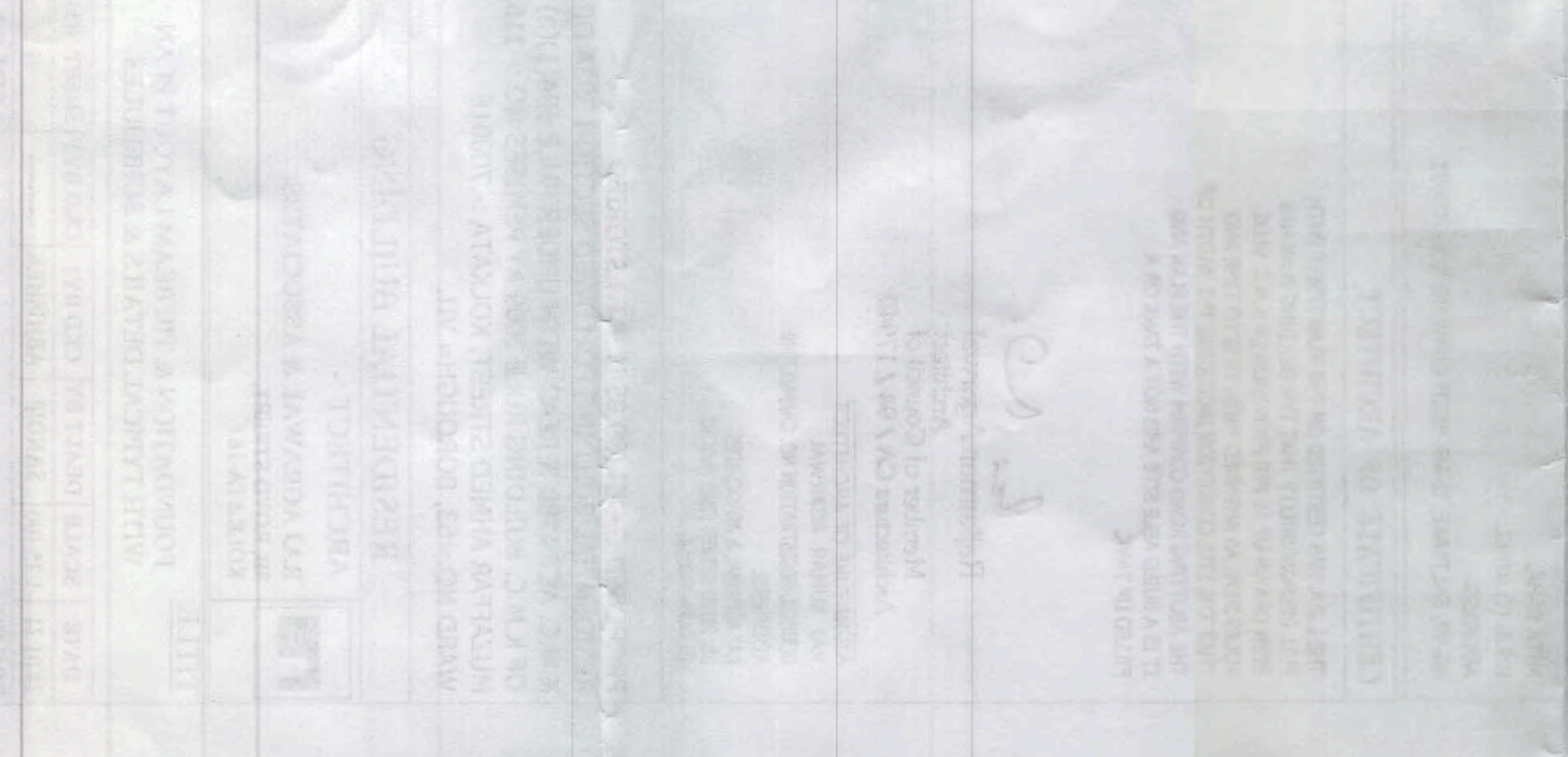

STRUCTURAL FORM AND DESIGN CALCULATION IS SUBMITTED BY THE
No. 203/2008/11 Date: 02/11/2011
of the Kodava Municipal Corporation without verification No.
owner from the structural student per. Work for me
along with design calculation and safety certificate in the
prescribed form, necessary steps shall be taken for the
safety of human life and property.

STRUCTURAL FORM AND DESIGN CALCULATION IS SUBMITTED BY THE
No. 203/2008/11 Date: 02/11/2011
of the Kodava Municipal Corporation without verification No.
owner from the structural student per. Work for me
along with design calculation and safety certificate in the
prescribed form, necessary steps shall be taken for the
safety of human life and property.

STRUCTURAL FORM AND DESIGN CALCULATION IS SUBMITTED BY THE
No. 203/2008/11 Date: 02/11/2011
of the Kodava Municipal Corporation without verification No.
owner from the structural student per. Work for me
along with design calculation and safety certificate in the
prescribed form, necessary steps shall be taken for the
safety of human life and property.

STRUCTURAL FORM AND DESIGN CALCULATION IS SUBMITTED BY THE
No. 203/2008/11 Date: 02/11/2011
of the Kodava Municipal Corporation without verification No.
owner from the structural student per. Work for me
along with design calculation and safety certificate in the
prescribed form, necessary steps shall be taken for the
safety of human life and property.

STRUCTURAL FORM AND DESIGN CALCULATION IS SUBMITTED BY THE
No. 203/2008/11 Date: 02/11/2011
of the Kodava Municipal Corporation without verification No.
owner from the structural student per. Work for me
along with design calculation and safety certificate in the
prescribed form, necessary steps shall be taken for the
safety of human life and property.

STRUCTURAL FORM AND DESIGN CALCULATION IS SUBMITTED BY THE
No. 203/2008/11 Date: 02/11/2011
of the Kodava Municipal Corporation without verification No.
owner from the structural student per. Work for me
along with design calculation and safety certificate in the
prescribed form, necessary steps shall be taken for the
safety of human life and property.